



**LOCKWOOD**

# Hydraulic Door Closers



An ASSA ABLOY Group brand

**ASSA ABLOY**

**Designed and manufactured to the exacting world standards. These world recognised standards ensure the highest possible quality, efficiency and reliable performance.**

**All models (except hold open) are tested and approved on Fire Doors in accordance with Australian standard AS1905:1:1997 Fire resistant door sets.**

**New multi functional designs offer the specifier, stockist or the installer outstanding versatility and low inventory levels.**

Effective door installation requires that the door and frame be of sufficient strength or reinforced to ensure secure anchorage of the door closer unit. A door fitted with a door closer must be hung on good quality aligned hinges so that the door swings freely without bias in both directions. The closed door must be clear in the door frame and when a lock is fitted the latch bolt must engage freely within the strike. When specifying manually operated door closers the following should be considered: door size, in particular width of door; door weight; type of installation; environmental conditions; location of door; operation frequency of door; the people using the door.

Door size and the pressure exerted on the surface area of the door due to wind gusts or airconditioning and the spring strength required to hold or close the door against this pressure must be considered along with the ability of the user to exert the force necessary to push or pull the door open. The location of door furniture will influence the leverage available to the person opening the door.



**7726 Series Adjustable Power Hydraulic Door Closers**



**7714 Series Adjustable Power Hydraulic Door Closers**



**7724 Series Adjustable Power Hydraulic Door Closers**



**3024 Series Selectable Power Hydraulic Door Closers**

# Hydraulic Door Closers

## Contents

<b>Description</b>	<b>Page</b>
<b>Door Closer Selection Guide</b>	<b>4</b>
<b>Features and Specifications</b>	<b>5</b>
<b>Standard Features Guide</b>	<b>6</b>
<b>7726 Standard Door Closer Series</b>	<b>7</b>
<b>7726 Slide Arm Door Closer Series</b>	<b>8</b>
<b>7714 Standard Door Closer Series</b>	<b>9</b>
<b>7714 Slide Arm Door Closer Series</b>	<b>10</b>
<b>7724 Standard Door Closer Series</b>	<b>11</b>
<b>7724 Slide Arm Door Closer Series</b>	<b>12</b>
<b>3024 Door Closer Series</b>	<b>13</b>
<b>Hold Open Series</b>	<b>14</b>
<b>Drop Plates and Glass Door Trim Plates</b>	<b>15</b>
<b>Lockwood Electro Mechanical Door Control Systems</b>	<b>16-17</b>
<b>Notes</b>	<b>18-19</b>

## Door Closer Selection Guide

Selection of door closer size is judged in two ways.

1. Does the door closer have the strength to effectively close the door against unexpected air pressures?
2. Is the door closer oversized for the application and therefore affecting the ease of operation?

Efficiency of the door closer also has a major bearing on ease of operation.

For optimum performance it is essential that a highly efficient door closer of a correct size is selected.

The use of spring strength adjustability, which allows fine tuning of strength on site, has simplified this task but not removed all of the guesswork. With more architects and engineers becoming conscious of the problems caused by incorrect selection of door closer strength, it has become the responsibility of manufacturers to provide better technical information, such as closing torque and efficiency of their products.

The following charts have been produced to cover most conditions.

If you have an unusual application which you feel requires special consideration, please forward all relevant information to your local office and we will be happy to advise the best door control for your application.

### FIRE RATED

Fire doors and pressurised stairwells pose significant challenges in ensuring closing and latching of fire doors. The problems are created by differential air pressures resulting from airconditioning systems, either on one or the other side of the door. To achieve complete fire safety, fire doors must latch securely at all times. If this performance is not achieved, the stairwell may be unsafe, and in the event of fire, loss of life and property may occur. Correct selection of door hardware is of paramount importance in ensuring that the appropriate operating standards are met.

Fire doors which open into a pressurised stairwell must meet the following criteria:

- the door must close against a pressure differential between the airconditioned floor area and non-airconditioned stairwell;
- the door must latch securely every time it closes;
- the door must be able to be opened with a force not exceeding 110N when the stairwell is pressurised; and
- the door must be protected from damage when it is opened by means of a backcheck action which is built into the door closer.

## Notes

Always round up to the next door width (ie for 870 mm door use 950 mm).

If parallel arm installation, then use next door width door line (ie, for 830 mm door use 950 mm).

For internal doors deduct 200 mm from actual door width (ie for 1250 mm internal door use 1050 line).

This chart is based on normal climatic conditions (ie pressure differential of 30Pa or wind of 15 knots).

If more severe conditions are expected then use the next door width or consult the office in your location (refer back page).

When specifying parallel arm and slide rail functions, allowance should be made for the following power loss:

### Parallel Arm Mounting

Approximately 20 per cent loss

### Slide Rail Mounting

Approximately 30 per cent loss

## Power Selection Chart

This chart will be most useful in selecting the correct door closer.

Simply identify the dimensions of the appropriate door and select the recommended door closer.

The chart is intended as a guide only and as such the following variations should be taken into account when making your selection:

- Environmental factors such as the effect of wind or airconditioning pressures.
- An unsheltered external door is a door on which prevailing wind gusts will directly produce a "sail area" affect.
- A sheltered external door is a door way which is protected by a wind break or wall, which acts as a barrier against direct wind gusts.

Closer Selection Chart

Door Width	Maximum Door Weight	Closer Size	Closing Torque	
			min	max
750	20kg	1	9 Nm	13 Nm
850	40kg	2	13 Nm	18 Nm
950	60kg	3	18 Nm	26 Nm
1100	80kg	4	26 Nm	37 Nm
1250	100kg	5	37 Nm	54 Nm
1400	120kg	6	54 Nm	87 Nm

All dimensions are in millimetres.

## Movement Curve

Slide arm pull side

Parallel arm push side

Note: Movement curve represents approximate forces required to operate a size 3 door closer.

Note: The illustration is an approximation based on one set of parameters. Any change to these parameters will result in a variation of performance.

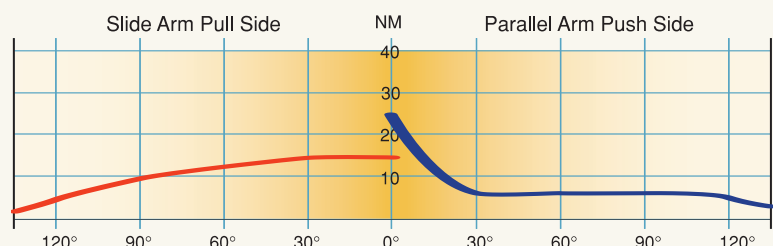

# Hydraulic Door Closers

## Features and Specifications

### Handing

Lockwood door closers are non-handed, therefore final assemblies are suitable for clockwise or anticlockwise opening door.

### Backcheck

Backcheck is a standard feature on all models in this series. Backcheck cushions or slows the opening movement of the door prior to reaching final open position. Backcheck intensity is adjustable to allow for door size, door weight and closing power. It is mandatory on all fire doors.

### Door Stops

Floor or wall mounted door stops should be fitted to prevent possible damage to the door unit or surrounds where a door may be subject to violent opening; to stop a door from being forced past the position where the arms are fully extended; or to stop a door at a specific position to clear feature walls, glass panels, furniture, etc.

### Delayed Action

The Delayed Action is an independent valve and can either be adjusted as part of the closing sequence or independently adjusted for delayed action.

Such doors are particularly suitable for use by the disabled, the aged and people with prams or trolleys.

### Sequence Selectors

When a pair of rebated doors are fitted with door closers it is essential that the doors close in their correct sequence. This closing sequence is achieved by the installation of a sequence selector.

### Materials

Extruded aluminium body with hard anodised coating. Alloy steel rack and pinion mechanism operated by silicon chrome alloy steel springs and forged steel arms.

### Standard Hold-Open

The hold-open device is located on the link arm and is activated by a cam. The position of the cam is adjustable to suit the desired hold-open position up to 150°. The operation of the hold-open device does not limit the angle to which the door may be opened, as the door may be pushed past the hold-open position without affecting its operation.

A firm push or pull on the door will release the hold-open device.

### Slide Rail Hold Open

Hold-open is a standard feature for all slide arm door closers.

Can be adjusted or disabled at any angle of the open arc.

### Fire Test

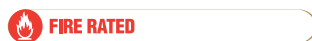

Approved on fire door assemblies up to 4HR, in accordance with Australian Standards AS1905 Part 1 – Fire Resistant Doors 1984.

### Pinion Needle Bearings

High grade pinion with precision needle bearings increases efficiency and minimises wear ensuring a prolonged operational life.

### Independently Adjustable Hydraulic Valves

Backcheck.  
Latching speed.  
Closing speed.

### Spring

Highest grade silicon chrome steel springs provide smooth action and long life.

### Overload Protection

Pressure relief valves are fitted to all units to prevent closer damage in the event of excessive force.

### Rack & Pinion

High grade alloy steel rack and pinion delivers a smooth and reliable action for the life of the door closer.

### Independent Delayed Action Valve

The Delayed Action is an independent valve and can be adjusted as part of the closing sequence or independently adjusted for delayed action.

### Power Adjustment Screw

The spring strength of the unit can be adjusted to the requirements of a specific door simply by turning the adjustment screw with the hex key supplied.

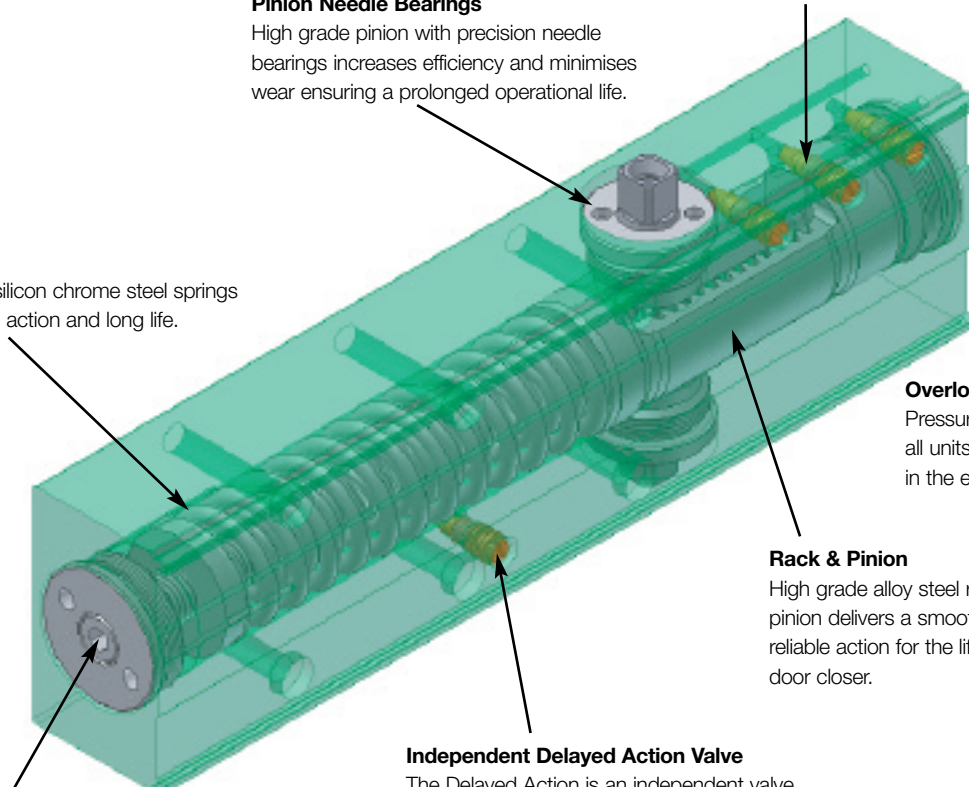

# Hydraulic Door Closers

## Standard Features

		<b>7726</b>	<b>7714</b>	<b>7724</b>	<b>3024</b>
<b>Materials</b>	Extruded Aluminium body with hard anodised coating	✓	✓	✓	✓
	Alloy Steel Rack & Pinion Mechanism	✓	✓	✓	✓
	Silicon Chrome Steel Alloy Springs	✓	✓	✓	✓
	Forged Steel Arms	✓	✓	✓	✓
	Fully Formed Stainless Steel Box Cover	✓	✓		
	Clip-on Cover			✓	✓
	High Grade Pinion Needle Bearings	✓	✓	✓	✓
<b>Power Adjustment</b>	Adjustable Power	✓	✓	✓	
	Adjustable Power - Position				✓
<b>Power Size</b>	Power Size 1		✓		
	Power Size 2	✓	✓	✓	✓
	Power Size 3	✓	✓	✓	✓
	Power Size 4	✓	✓	✓	✓
	Power Size 5	✓			
	Power Size 6	✓			
<b>Features</b>	Backcheck	✓	✓	✓	✓
	Delayed Action	✓	✓		
	Non-Handed	✓	✓	✓	✓
	Overload Protection	✓	✓	✓	✓
	Standard Arm	✓	✓	✓	✓
	Slide Arm	✓	✓	✓	
	Over Door Mounting	✓	✓	✓	✓
	Standard Hold Open	✓	✓	✓	✓
	Slide Arm Hold Open	✓	✓	✓	
	Fire Rated	✓	✓	✓	✓
<b>Finish</b>	Satin Stainless Steel	✓	✓		
	Polished Stainless Steel	✓	✓		
	Gold PVD on Stainless Steel	✓	✓		
	Brown			✓	✓
	Silver			✓	✓
	Black			✓	✓
	Gold			✓	✓

# Hydraulic Door Closers

## 7726 Door Closer Series

A range of adjustable power door closer units suitable for architectural and commercial applications.

### Standard Features

- Stainless Steel Cover.
- 2 – 6 Power Adjustable.
- Delayed Action.
- Adjustable Backcheck.
- Speed Controls.
- Overload Protection.
- Non-Handed.
- Regular, Parallel & Over Door mounting.

### Hold Open

Hold open can be set at any angle up to 150° of opening.

### Standard Finishes

- |                          |     |
|--------------------------|-----|
| Satin Stainless Steel    | SSS |
| Polished Stainless Steel | PSS |
| Bright Gold              | GLD |



Approved on fire door assemblies up to 4HR, in accordance with Australian Standards AS1905 Part 1 – Fire Resistant Doors 1984.



### 7726 Standard Arm

Closer installed on pull side of door.  
This mounting position permits opening of 180°.

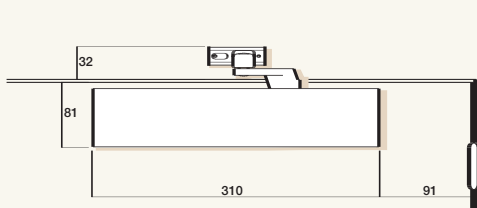

### Part Numbers

- |               |              |
|---------------|--------------|
| Non hold open | <b>7726</b>  |
| Hold Open     | <b>7726H</b> |

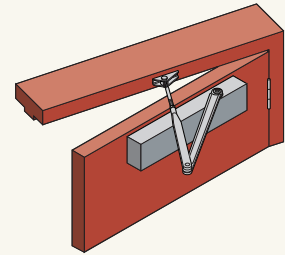
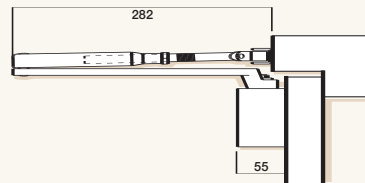

### 7726 Parallel Arm

Closer installed on push side of door.  
This mounting position permits opening of 180°.

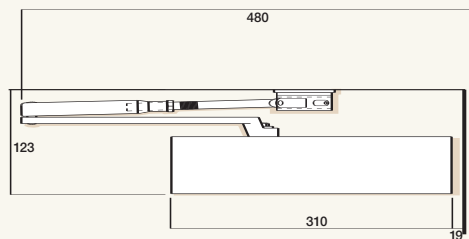

### Part Numbers

- |               |              |
|---------------|--------------|
| Non hold open | <b>7726</b>  |
| Hold Open     | <b>7726H</b> |

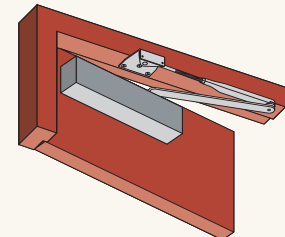
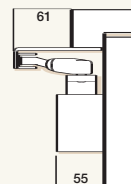

### 7726 Over Door Mounting

Closer installed on push side of door and top rail where conditions do not allow parallel mounting.  
This mounting position permits opening of 180°.

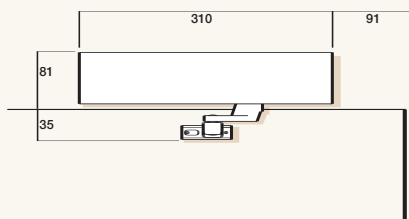

### Part Numbers

- |               |              |
|---------------|--------------|
| Non hold open | <b>7726</b>  |
| Hold Open     | <b>7726H</b> |

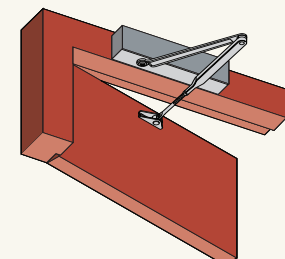
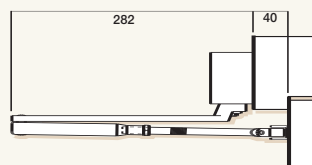

# Hydraulic Door Closers

## 7726 Slide Arm Door Closer Series

The Slide Arm Series permits smoother opening by way of reducing power as the door opens. Ideally suited for schools, hospitals or doors where children, disabled or the aged may enter.

### Standard Features

- Stainless Steel Cover.
- 2 – 5 Power Adjustable.
- Delayed Action.
- Adjustable Hold Open (Inclusive).
- Adjustable Backcheck.
- Speed Controls.
- Overload Protection.
- Non-Handed.
- Regular & Over Door mounting.

### Hold Open

Hold open angle is the same as opening angle.

### Standard Finishes

Satin Stainless Steel	SSS
Polished Stainless Steel	PSS
Bright Gold	GLD



Approved on fire door assemblies up to 4HR, in accordance with Australian Standards AS1905 Part 1 – Fire Resistant Doors 1984.



### 7726 Slide Arm Pull Side

Closer installed on pull side of door.

This mounting position permits opening of 175°.

### Part Numbers

**7726SR**

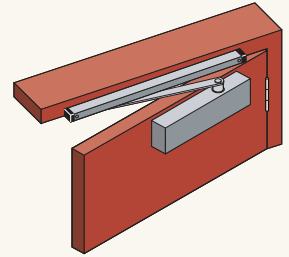
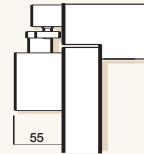
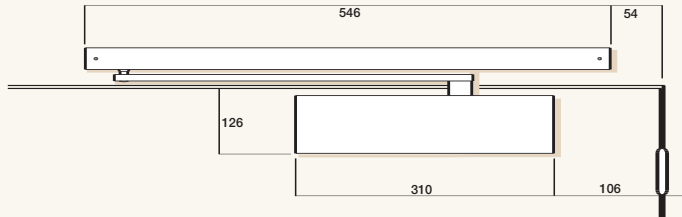

### 7726 Slide Arm Push Side

Closer installed on push side of door.

This mounting position permits opening of 130°.

### Part Numbers

**7726SR**

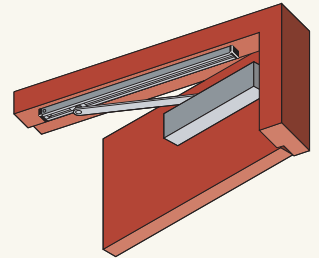
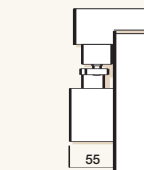
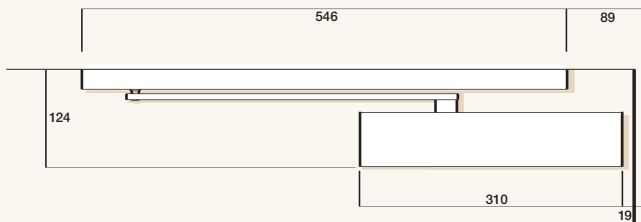

### 7726 Slide Arm Over Door Mounting

Closer installed on push side of door and top rail where conditions do not allow parallel mounting. This mounting position permits opening of 130°.

### Part Numbers

**7726SR**

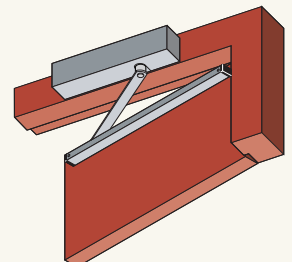
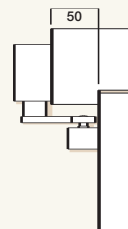
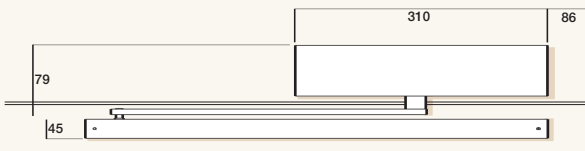

# Hydraulic Door Closers

## 7714 Door Closer Series

A range of adjustable power door closer units suitable for architectural and commercial applications.

### Standard Features

- Stainless Steel Cover.
- 1 – 4 Power Adjustable.
- Delayed Action.
- Hold Open.
- Adjustable Backcheck.
- Speed Controls.
- Overload Protection.
- Non-Handed.
- Regular, Parallel & Over Door mounting.

### Hold Open

Hold open can be set at any angle up to 150° of opening.

### Standard Finishes

- |                          |     |
|--------------------------|-----|
| Satin Stainless Steel    | SSS |
| Polished Stainless Steel | PSS |
| Bright Gold              | GLD |



Approved on fire door assemblies up to 4HR, in accordance with Australian Standards AS1905 Part 1 – Fire Resistant Doors 1984.



### 7714 Standard Arm

Closer installed on pull side of door. This mounting position permits opening of 180°.

#### Part Numbers

- |               |              |
|---------------|--------------|
| Non hold open | <b>7714</b>  |
| Hold Open     | <b>7714H</b> |

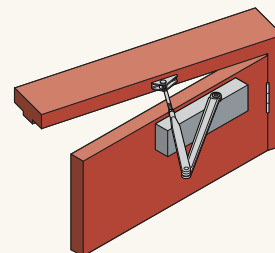
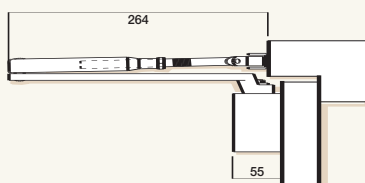
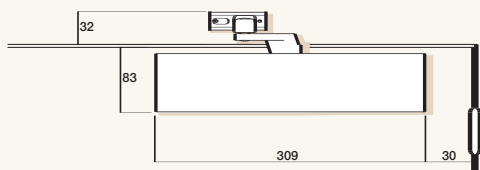

### 7714 Parallel Arm

Closer installed on push side of door. This mounting position permits opening of 180°.

#### Part Numbers

- |               |              |
|---------------|--------------|
| Non hold open | <b>7714</b>  |
| Hold Open     | <b>7714H</b> |

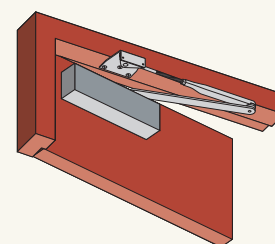
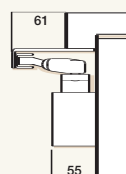
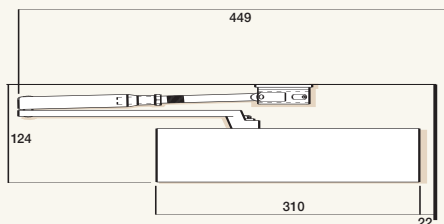

### 7714 Over Door Mounting

Closer installed on push side of door and top rail where conditions do not allow parallel mounting. This mounting position permits opening of 180°.

#### Part Numbers

- |               |              |
|---------------|--------------|
| Non hold open | <b>7714</b>  |
| Hold Open     | <b>7714H</b> |

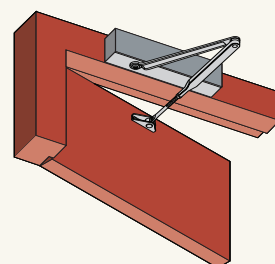
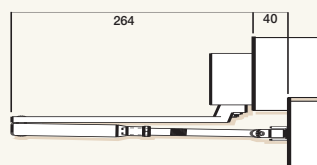
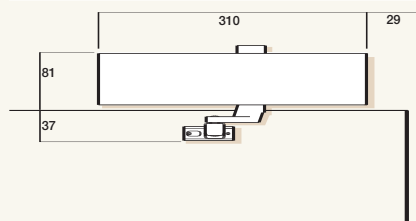

# Hydraulic Door Closers

## 7714 Slide Arm Door Closer Series

The Slide Arm Series permits smoother opening by way of reducing power as the door opens. Ideally suited for schools, hospitals or doors where children, disabled or the aged may enter.

### Standard Features

- Stainless Steel Cover.
- 1 – 3 Power Adjustable.
- Delayed Action.
- Adjustable Hold Open (Inclusive).
- Adjustable Backcheck.
- Speed Controls.
- Overload Protection.
- Non-Handed.
- Regular & Over Door mounting.

### Hold Open

Hold open angle is the same as opening angle.

### Standard Finishes

Satin Stainless Steel	SSS
Polished Stainless Steel	PSS
Bright Gold	GLD



Approved on fire door assemblies up to 4HR, in accordance with Australian Standards AS1905 Part 1 – Fire Resistant Doors 1984.



### 7714 Slide Arm Pull Side

Closer installed on pull side of door.  
This mounting position permits opening of 175°.

Part Numbers  
**7714SR**

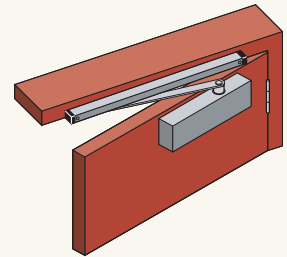
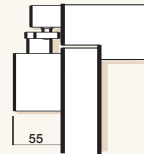
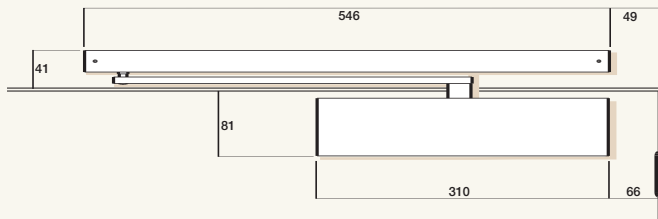

### 7714 Slide Arm Push Side

Closer installed on push side of door.  
This mounting position permits opening of 130°.

Part Numbers  
**7714SR**

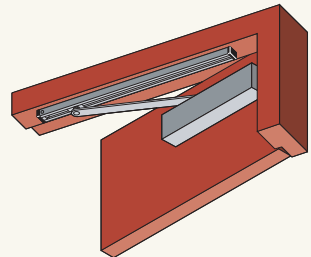
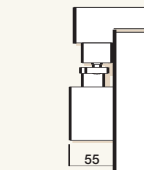
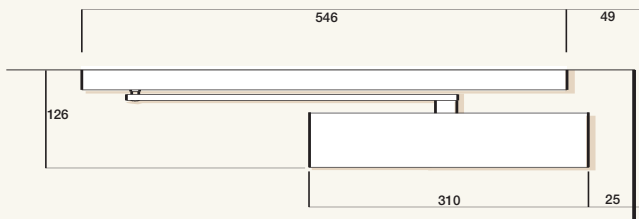

### 7714 Slide Arm Over Door Mounting

Closer installed on push side of door and top rail where conditions do not allow parallel mounting.  
This mounting position permits opening of 130°.

Part Numbers  
**7714SR**

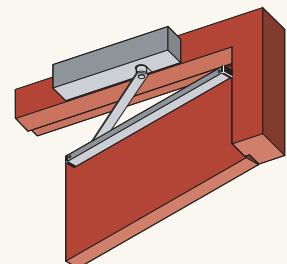
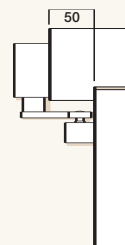
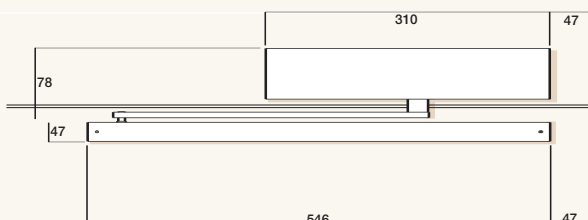

# Hydraulic Door Closers

## 7724 Door Closer Series

A range of adjustable power door closer units suitable for architectural and commercial applications.

### Standard Features

- 2 – 4 Power Adjustable.
- Hold Open.
- Adjustable Backcheck.
- Speed Controls.
- Overload Protection.
- Non-Handed.
- Regular, Parallel & Over Door mounting.
- Short Arm - to suit 400 mm width door.
- SP7724-130SIL

### Hold Open

Hold open can be set at any angle up to 150° of opening.

### Standard Finishes

- |        |     |
|--------|-----|
| Silver | SIL |
| Gold   | GLD |
| Brown  | BRN |
| Black  | BLK |
- Other finishes available on request.



Approved on fire door assemblies up to 4HR, in accordance with Australian Standards AS1905 Part 1 – Fire Resistant Doors 1984.



### 7724 Standard Arm

Closer installed on pull side of door. This mounting position permits opening of 180°.

#### Part Numbers

- |               |              |
|---------------|--------------|
| Non hold open | <b>7724</b>  |
| Hold Open     | <b>7724H</b> |

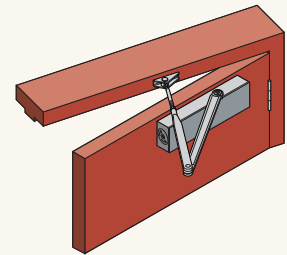
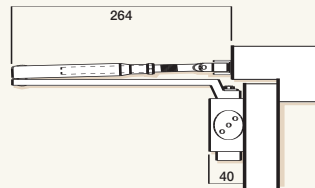
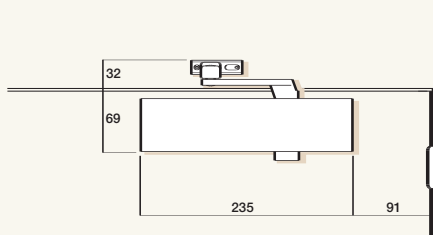

### 7724 Parallel Arm

Closer installed on push side of door. This mounting position permits opening of 180°.

#### Part Numbers

- |               |              |
|---------------|--------------|
| Non hold open | <b>7724</b>  |
| Hold Open     | <b>7724H</b> |

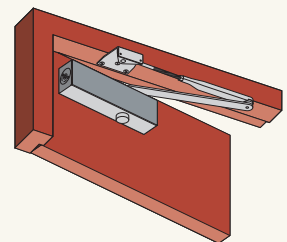
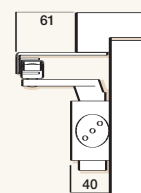
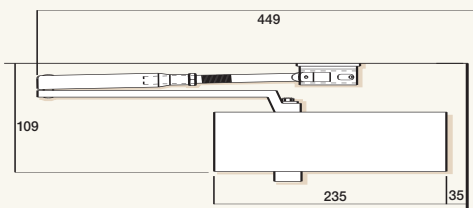

### 7724 Over-Door Mounting

Closer installed on push side of door and top rail where conditions do not allow parallel mounting. This mounting position permits opening of 180°.

#### Part Numbers

- |               |              |
|---------------|--------------|
| Non hold open | <b>7724</b>  |
| Hold Open     | <b>7724H</b> |

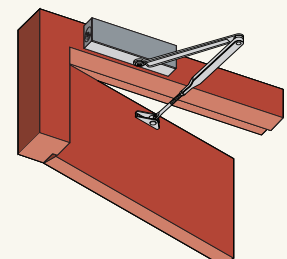
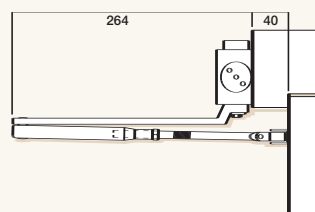
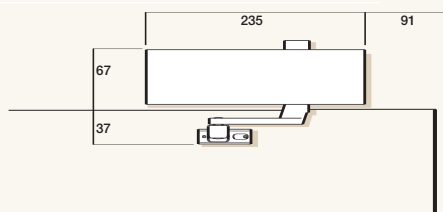

# Hydraulic Door Closers

## 7724 Slide Arm Door Closer Series

The Slide Arm Series permits smoother opening by way of reducing power as the door opens. Ideally suited for schools, hospitals or doors where children, disabled or the aged may enter.

### Standard Features

- 2 – 3 Power Adjustable.
- Adjustable Hold Open (Inclusive).
- Adjustable Backcheck.
- Speed Controls.
- Overload Protection.
- Non-Handed.
- Regular & Over Door mounting.

### Hold Open

Hold open angle is the same as opening angle.

### Standard Finishes

Silver	SIL
Brown	BRN
Gold	GLD
Black	BLK



Approved on fire door assemblies up to 4HR, in accordance with Australian Standards AS1905 Part 1 – Fire Resistant Doors 1984.



### 7724 Slide Arm Pull Side

Closer installed on pull side of door.

This mounting position permits opening of 175°.

### Part Numbers

**7724SR**

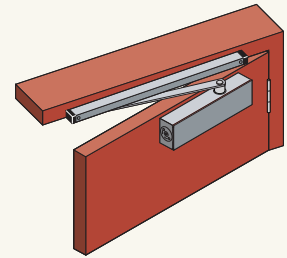
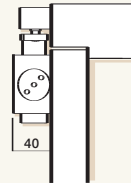
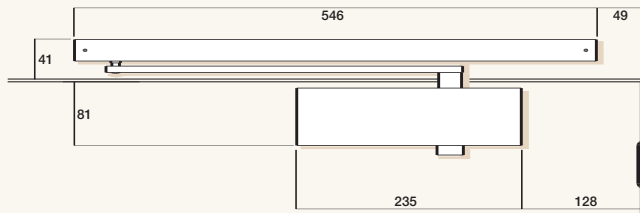

### 7724 Slide Arm Push Side

Closer installed on push side of door.

This mounting position permits opening of 130°.

### Part Numbers

**7724SR**

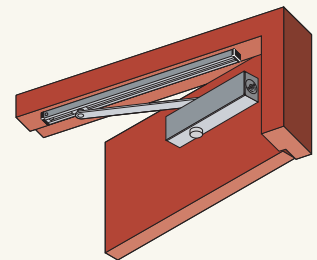
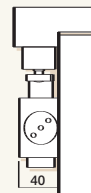
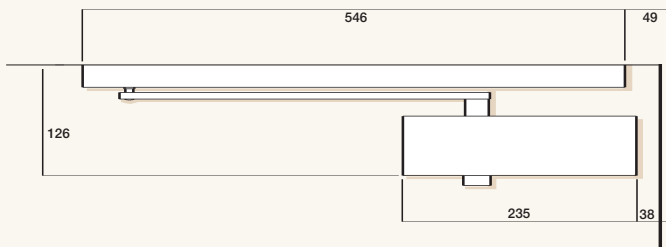

### 7724 Slide Arm Over Door Mounting

Closer installed on push side of door and top rail where conditions do not allow parallel mounting. This mounting position permits opening of 130°.

### Part Numbers

**7724SR**

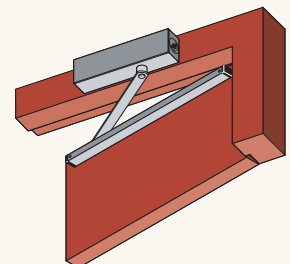
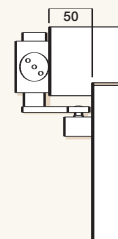
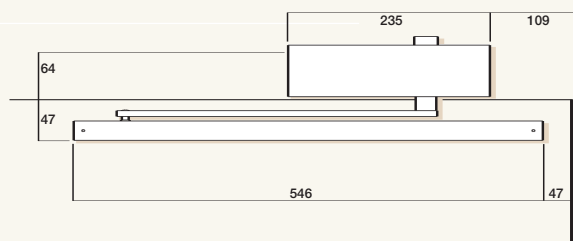

# Hydraulic Door Closers

## 3024 Door Closer Series

A range of power selectable door closer units suitable for architectural and commercial applications.

### Standard Features

- 2 – 4 Power Selectable.
- Hold Open.
- Adjustable Backcheck.
- Speed Controls.
- Overload Protection.
- Non-Handed.
- Regular, Parallel & Over Door mounting.

### Hold Open

Hold open can be set at any angle up to 150° of opening.

### Standard Finishes

- |        |     |
|--------|-----|
| Brown  | BRN |
| Silver | SIL |
| Gold   | GLD |
| Black  | BLK |
- Other finishes available on request.



Approved on fire door assemblies up to 4HR, in accordance with Australian Standards AS1905 Part 1 – Fire Resistant Doors 1984.



### 3024 Standard Arm

Closer installed on pull side of door.  
This mounting position permits opening of 180°.

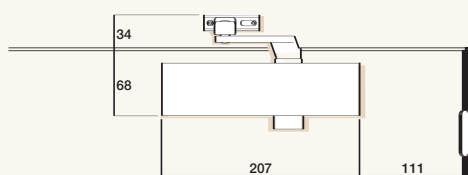

#### Part Numbers

- |               |              |
|---------------|--------------|
| Non hold open | <b>3024</b>  |
| Hold Open     | <b>3024H</b> |

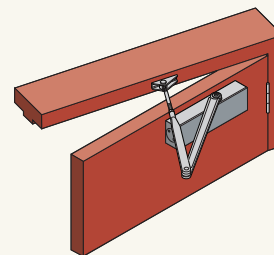
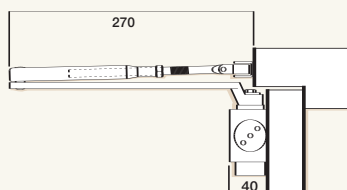

### 3024 Parallel Arm

Closer installed on push side of door.  
This mounting position permits opening of 180°.

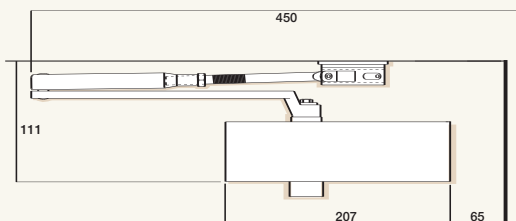

#### Part Numbers

- |               |              |
|---------------|--------------|
| Non hold open | <b>3024</b>  |
| Hold Open     | <b>3024H</b> |

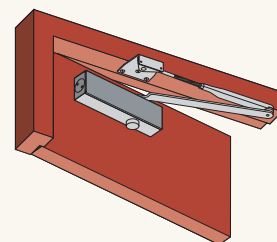
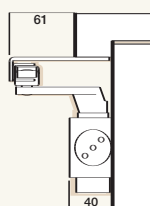

### 3024 Over-Door Mounting

Closer installed on push side of door and top rail where conditions do not allow parallel mounting. Standard mounting position permits opening of 180°.

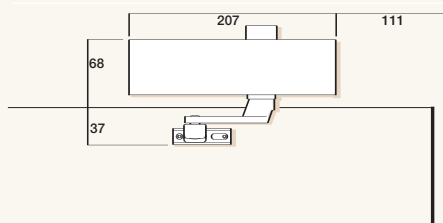

#### Part Numbers

- |               |              |
|---------------|--------------|
| Non hold open | <b>3024</b>  |
| Hold Open     | <b>3024H</b> |

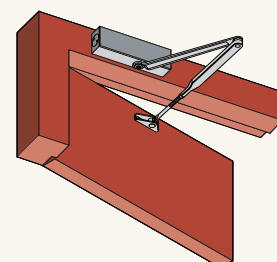
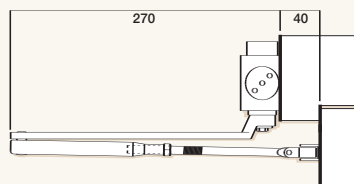

## Hydraulic Door Closers

### Standard Hold Open Arm

#### Description

Surface mounted on push or pull side of door. To hold the door open at any angle until the hold-open function is positively released by a slight pull action. Adjustable up to 150° angle of the door closer opening range.

#### Features & Specifications

The Hold Open Arm is suitable for both standard and parallel mounting. The link arm is forged steel with a steel main arm finished in baked enamel.

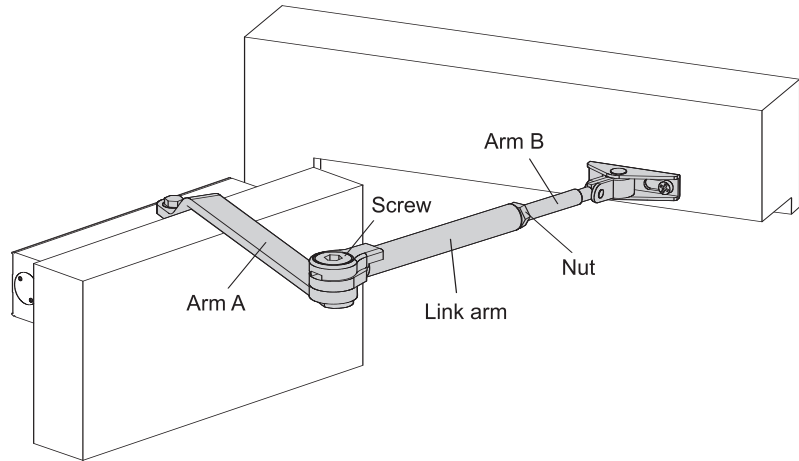

### Slide Arm Hold Open

#### Adjustable Hold Open Device

To set the hold open angle move hold open device to required position and firmly tighten screw.

If Hold Open is not required do not tighten HO screw.

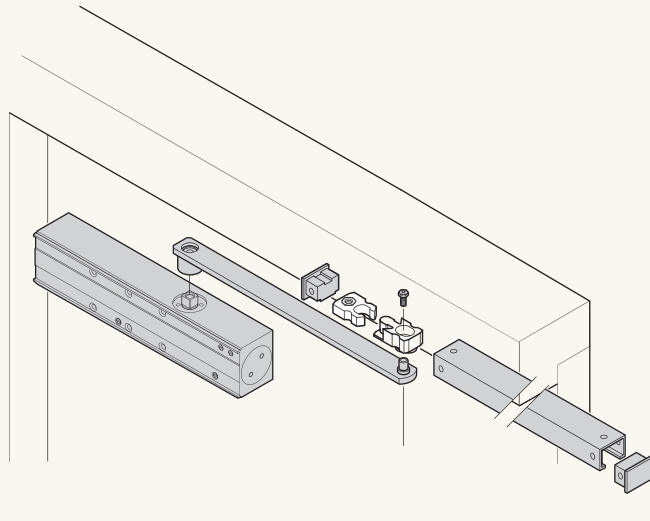

### Delayed Action

The Delayed Action is an independent valve and can either be adjusted as part of the closing sequence or independently adjusted for delayed action.

#### Closing sequence with Delayed Action

D = 130° - 70° Control door speed with Delayed Action valve

B = 70° - 15° Control door speed with Closing valve

A = 15° - 0° Control door speed with Latching valve

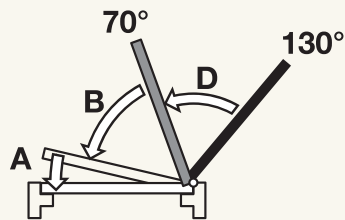

# Hydraulic Door Closers

## Drop Plates and Glass Door Trim Plates Series

### 7726/7714 Drop Plate

Drop plate is available for fixing to doors with a small top rail.  
 Four drilled and tapped holes are provided for easy installation  
 or door closer.  
 Fitting of drop plate does not lower the position of door closer.  
 Suitable for Parallel Arm & Slide Arm. Push side applications only.

**Part Number**  
**7726-180SIL**

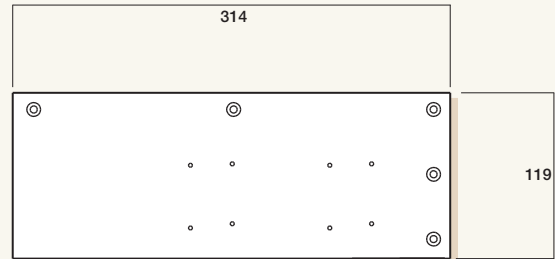

### 7724 Drop Plate

Drop plate is available for fixing to doors with a small top rail.  
 Four drilled and tapped holes are provided for easy installation  
 of door closer.  
 Fitting of drop plate does not lower the position of door closer.  
 Suitable for Parallel Arm & Slide Arm. Push side applications only.

**Part Number**  
**7724-180SIL**

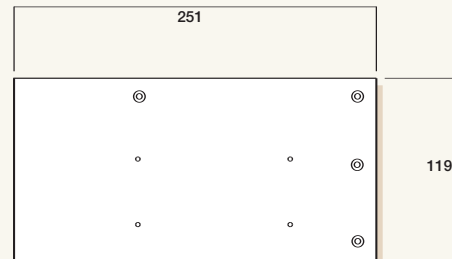

### 3024 Drop Plate

Drop plate is available for fixing to doors with a small top rail.  
 Four drilled and tapped holes are provided for easy installation  
 of door closer.  
 Fitting of drop plate does not lower the position of door closer.  
 Suitable for Parallel Arm & Slide Arm. Push side applications only.

**Part Number**  
**3024-180SIL**

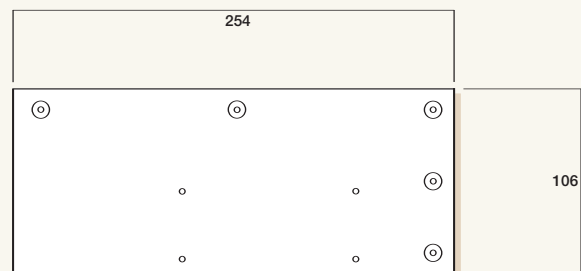

### 3024 Trim Plate

When a closer is mounted to a glazed door the closer may  
 project below the top rail.  
 To enhance the appearance as seen through the glass, a trim  
 plate is available that conceals the back of the closer.  
 Also for regular and over door mounting on narrow aluminium  
 frames. Pull side applications only.

**Part Number**  
**3024-173SIL**

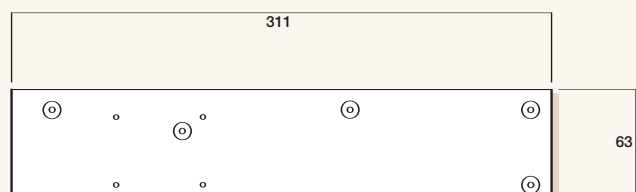

# Hydraulic Door Closers

## Lockwood Electro Mechanical Door Control Systems

**It is vital for fire doors to close in the event of fire. The fire door must close and latch automatically in order to limit the spread of fire into the other parts of the building. During daytime the normal use of a fire door may require the doors to remain open.**

Lockwood fire door closing systems guarantee easy access and convenience for use in normal situations as well as maximum security in the event of fire. Lockwood fire door closing systems are composed of reliable and compatible components that enable building up a safe, individual solution for each application.

### Major Features

#### Design

Compact modern design to suit both single and double door installations.

#### Flexibility In Installation

- easy to install on narrow frames (40 mm).
- one unit suits both push side or pull side.

#### Door Sizes

- single door applications minimum 350 mm, maximum 1250 mm.
- double door applications minimum 1350 mm, maximum 2500 mm.



#### Offset To Door Stop

- pull side - maximum 18 mm.
- push side - maximum 30 mm.
- maximum distance between face of architrave and centre line of hinge is 90 mm.

#### Hold-Open Device

- easy to install with adjustable angles (90° to 130°).
- hold-open strength can be adjusted during the installation.

#### Opening Angles

Maximum opening angle

- Push Side, 120°.
- Pull Side, 130°.

#### Electrical Specifications

24V DC ± 15%. Low consumption: max. current 60mA per hold-open device.

#### Co-ordinator (Double Doors)

When a pair of rebated doors are fitted with the door closers it is essential that the doors close in their correct sequence.

- built in sequence selector holds the inactive door open independently until the active door has closed.
- guarantees the doors closing in the correct order with accurate closing times.



The Lockwood Electro magnetic Door Control System has been successfully fire tested up to 4 hours (depending on type of fire door) on fire door assemblies in accordance with Australian Standard AS1905.1:1997 - Part 1: Fire resistant doorsets.

## Lockwood Electro Mechanical Door Control Systems

### Fire Door Closing System

An example of the operation and main components of a fire door closing system.

If fire doors are held open they must close at the break out of fire, so that smoke and flames can be retained and not spread throughout the building.

The smoke detector (1) reacts to smoke and activates the alarm to switch off the hold-open device of the door (2) The door closer (3) controls the door to close and latch into the shut position (4) add optional release button clipsal 30 MBP and mounting plate.

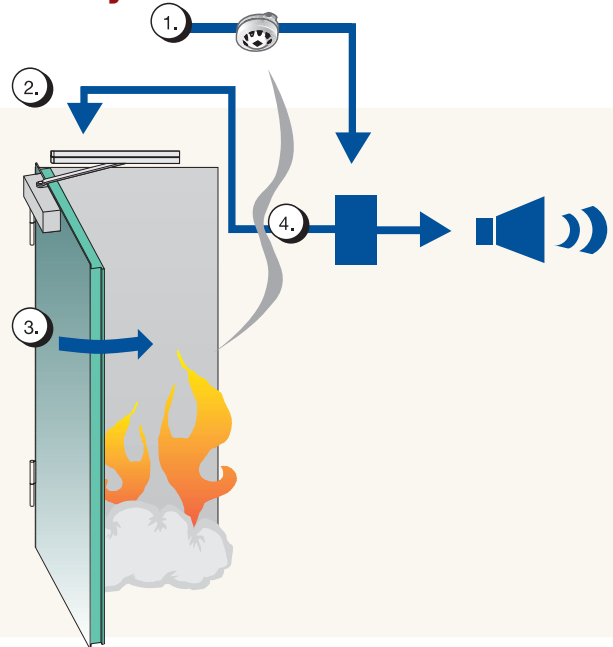

### Ordering Procedures

7726 Series

**7726**

**EMC**

Single Door Unit

**SSS**

**PSS**

**EMCD**

Double Door Unit  
with Door Co-ordinator

**GLD**

**BRN**

# Hydraulic Door Closers

## Lockwood Electro Mechanical Door Control Systems

### 7726 Series

#### Single Door Function



#### Double Door Function

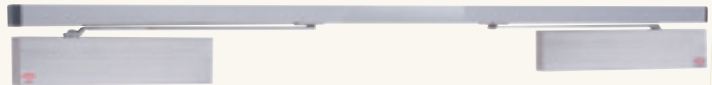

#### Limiting Dimensions - Pull Side / Right Hand Door

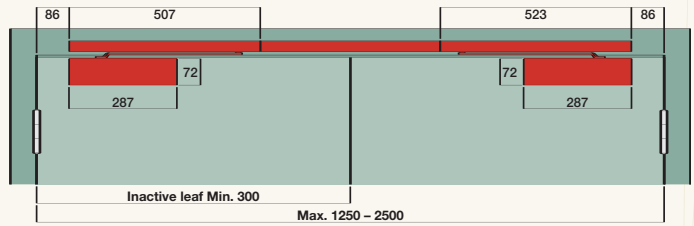
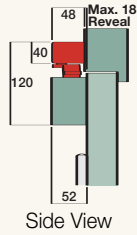
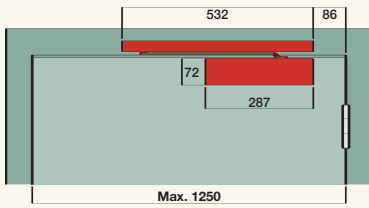

#### Limiting Dimensions - Push Side / Right Hand Door

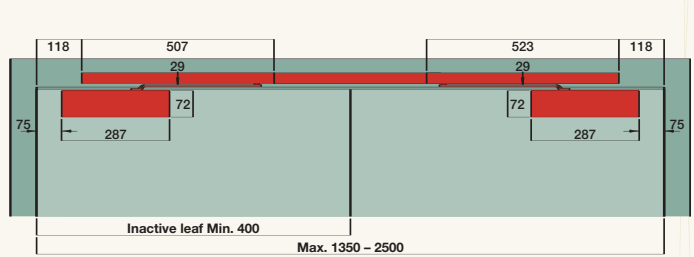
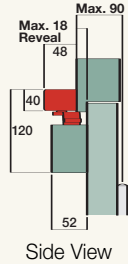
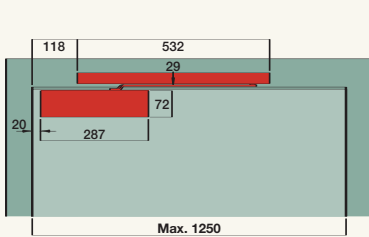

### 7726 Series Accessory Installation Examples

#### Flat mounting plate 7726-103 for single doors (Double doors X 2)

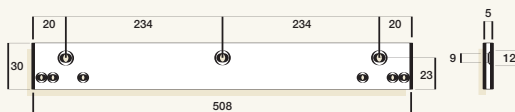
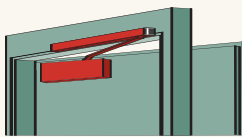

#### Flat mounting plate 7726-103 for single doors (Double doors X 2)

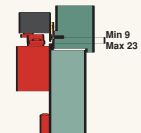
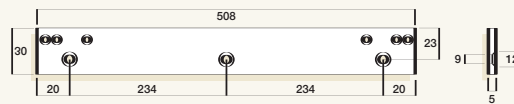
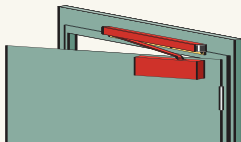

#### Angle mounting plate 7726-105 for single doors (Double doors: 2 X 7726-105 plus centre piece 7726-109)

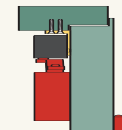
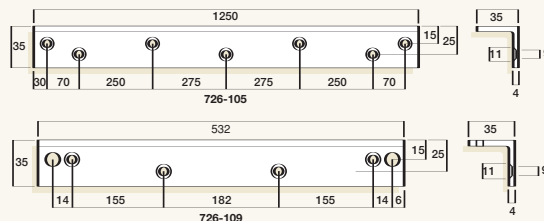
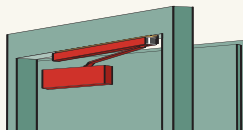







LOCK UP WITH LOCKWOOD®

Visit us at: [www.assaabloypacific.com](http://www.assaabloypacific.com)

## ASSA ABLOY Sales Offices & Authorised Agents in Asia Pacific

### Sales Offices - Australia

#### Victoria – Head Office

50 Edward Street  
Oakleigh VIC 3166  
Telephone (03) 8574 3888  
Facsimile (03) 8574 3788

#### Queensland South

450 Sherwood Road  
Sherwood QLD 4075  
Telephone (07) 3373 5200  
Facsimile (07) 3373 5256

#### Queensland North

Ralph Buck Agencies  
15 Mackley Street  
Garbutt QLD 4814  
Telephone (07) 4779 0177  
Facsimile (07) 4775 1480

#### New South Wales – Commercial

Unit 1/16 Atkinson Road  
Taren Point NSW 2229  
Telephone (02) 8543 3700  
Facsimile (02) 9531 7944

#### New South Wales – Residential

Unit 5/30 Foundry Road  
Seven Hills NSW 2147  
Telephone (02) 9624 2666  
Facsimile (02) 9620 9340

#### Abloy Security

5/372 Eastern Valley Way  
Chatswood NSW 2067  
Telephone (02) 9882 6066

#### South Australia

182 Magill Road  
Norwood SA 5067  
Telephone (08) 8139 0403  
Facsimile (08) 8364 1975

#### Western Australia

45 Gladstone Street  
East Perth WA 6004  
Telephone (08) 9227 9588  
Facsimile (08) 9227 8913

#### Tasmania

23 Antill Street  
South Hobart TAS 7000  
Telephone (03) 6223 5404  
Facsimile (03) 6224 0435

### Sales Offices - New Zealand

#### Auckland – Commercial

10 Haultain Street, Eden Terrace  
Auckland, New Zealand  
Telephone +64 (0)9 634 5590  
Facsimile +64 (0)9 634 5589

#### Auckland – Residential

6 Armstrong Road  
North Harbour Industrial Estate  
Albany, Auckland, New Zealand  
Telephone +64 (0)9 415 7111  
Facsimile +64 (0)9 415 7222

#### Christchurch

112 Wordsworth Street, Sydenham  
Christchurch, New Zealand  
Telephone +64 (0)3 348 2294  
Facsimile +64 (0)3 379 4819

#### Wellington

Display Centre, Level 3,  
10 Hutt Road, Petone  
Wellington, New Zealand  
Telephone +64 (0)4 913 4214  
Facsimile +64 (0)4 913 4213

### Manufacturing Plants

#### Victoria

50 Edward Street  
Oakleigh VIC 3166  
Telephone (03) 8574 3888  
Facsimile (03) 8574 3788

#### Queensland

450 Sherwood Road  
Sherwood QLD 4075  
Telephone (07) 3373 5200  
Facsimile (07) 3373 5256

#### New Zealand

6 Armstrong Road  
North Harbour Industrial Estate  
Albany, Auckland New Zealand  
Telephone +64 (0)9 415 7111  
Facsimile +64 (0)9 415 7222



### Export Department

50 Edward Street  
Oakleigh VIC 3166 Australia  
Telephone +61 (0)3 8574 3888  
Facsimile +61 (0)3 8574 3789

### Asian Offices

#### ASSA ABLOY – Malaysia

#### ASSA ABLOY – Singapore

#### ASSA ABLOY – Thailand

#### ASSA ABLOY – Hong Kong

#### ASSA ABLOY – Shanghai

#### ASSA ABLOY – Beijing

#### ASSA ABLOY – Korea

Contact the Export Department,  
Australia for details.

### Worldwide Distributors

Contact the Export Department,  
Australia for details.

## ASSA ABLOY

### Lockwood Guarantee

ASSA ABLOY Australia Pty Limited ("ASSA ABLOY") guarantees its Lockwood products against defects in workmanship and materials. If within the normal working life of a product it is found to be defective, ASSA ABLOY will supply the same or equivalent product free of charge.

All electrical and electronic components used in ASSA ABLOY's range of products excluding batteries are guaranteed for a period of 12 months from the date of proof of purchase, unless stated otherwise.

ASSA ABLOY assumes no liability under the guarantee for the following:

1. Improper installation or failure to follow fitting instructions.
2. Failure due to improper maintenance.
3. Failure due to fair wear and tear.
4. Indirect or consequential loss or damage.
5. Cost of removal and/or replacement.

6. Cost of freight and/or travelling time.

7. The plated finishes Florentine Bronze, Architectural Bronze, Polished Brass, Gold and Satin Brass, "which" are classified as soft finishes. As deterioration is possible under some environmental conditions, these finishes are excluded from this guarantee.

8. Any modification or repairs to a product, as supplied, unless authorised by ASSA ABLOY Australia Pty Limited.

9. Use of replacement parts other than authorised parts.

10. Malfunction or failure of the product due to the use of non-genuine Lockwood parts.

11. Malfunction or failure of the product due to the use of non-specified batteries.

Nothing in the ASSA ABLOY Australia Pty Limited guarantee excludes, restricts or modifies any condition, warranty, right or liability implied or protected by law where to do so would render the Guarantee, or any part of it, void.

